

# End clamp

RED · COMPATIBLE WITH SILK<sup>®</sup> RED MODULES

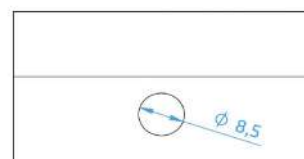
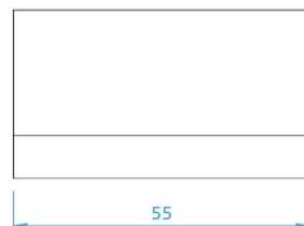
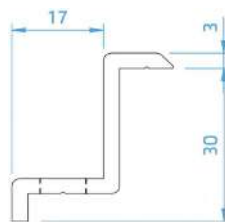

## Components and materials

Perforated RAL3005 powder-coated aluminium clamp

## Supply method

The article is sold and packaged in a pack of 10 pcs

## Code

FUMT.30.SV.R3005

## Module thickness [ mm ]

30

## Material characteristics

Raw material origin	Low carbon footprint
Nomenclature EN 755-2	EN AW 6063
Heat treatment	T6
Tensile strength $R_m$ (MPa)	215
Limit elasticity load $R_{p0,2}$ (MPa)	170
Elongation over 50 mm (%)	8
Hardness HB	70
Coefficient of linear thermal expansion between 20°C and 100°C (1/°K)	$23 \times 10^{-6}$
Paint certification	QUALICOAT Class 1 - resistant to sunlight and weathering

## Environmental impact

Aluminium with a low carbon footprint is used in the extrusion of this profile. The use of hydroelectric, wind and solar renewable energy sources in production allows the carbon footprint to be reduced to 4.0 kg of CO<sub>2</sub> per kg of aluminium, less than a quarter of the global average. The production of the raw material is verified according to ISO 14064 by DNV GL covering all carbon emissions from bauxite extraction and alumina refining to aluminium production in electrolysis and smelting.

## Disclaimer

All images shown are for illustration purposes only; product appearance and colour reference (RAL) may vary depending on installation, light and reflection.

All text and images are the exclusive property of the manufacturer and protected under copyright law no. 633 of 1941. Full or partial reproduction or modification, are therefore prohibited, except for use as specifications. The information included in this product data sheet is subject to change without notice. No contractual rights are established or to be inferred as a result of the user's reliance on the information contained in this data sheet.

The manufacturer only guarantees that the materials used and the finished product comply with the technical and performance characteristics specified in the data sheet and the applicable regulations and that the product is suitable for the intended use only. On the other hand, it is the sole responsibility of the purchaser, the designer responsible for the system and the installer to assess the suitability of the product in meeting the requirements of the specific project in which it is to be used, to verify the suitability of the installation site and the technical and performance characteristics of the product itself, including structural calculations, where required by the standard or rule of art. The manufacturer shall therefore accept no liability for damage that is not directly attributable to defects in product conformity, such as, but not limited to: incorrect or omitted assessment of the performance characteristics of the entire system and supports, incorrect or improper methods of installation and use of the product, use for applications other than those for which the product was designed or incorrect or omitted assessment of the permissible loads of the structures involved.